

TOWN AND COUNTRY PLANNING ACT 1990
THE LAND AT 273-281 INGROW LANE, KEIGHLEY
TREE PRESERVATION ORDER 2016

The City of Bradford Metropolitan District Council in exercise of the powers conferred on them by Section 198 of the Town and Country Planning Act 1990 make the following Order:-

Citation

1. This Order may be cited as land at 273-281 Ingrow Lane, Keighley – Tree Preservation Order 2016

Interpretation

2. (1) In this Order “the authority” means City of Bradford Metropolitan District Council.
- (2) In this Order any reference to a numbered section is a reference to the section so numbered in the Town and Country Planning Act 1990 and any reference to a numbered regulation is a reference to the regulation so numbered in the Town and Country Planning Act (Tree Preservation) (England) Regulations 2012.

Effect

3. (1) Subject to article 4, this Order takes effect provisionally on the date on which it is made.
- (2) Without prejudice to subsection (7) of section 198 (power to make tree preservation orders) or subsection (1) of section 200 (tree preservation orders: Forestry Commissioners) and, subject to the exception in regulation 14, no person shall:-
 - (a) cut down, top, lop, uproot, wilfully damage, or wilfully destroy; or
 - (b) cause or permit the cutting down, topping, lopping, wilful damage or wilful destruction of,

any tree specified in the Schedule to this Order except with the written consent of the authority in accordance with regulations 16

TREE PRESERVATION ORDER 16/00012/A
LAND AT 273 - 281 INGROW LANE KEIGHLEY

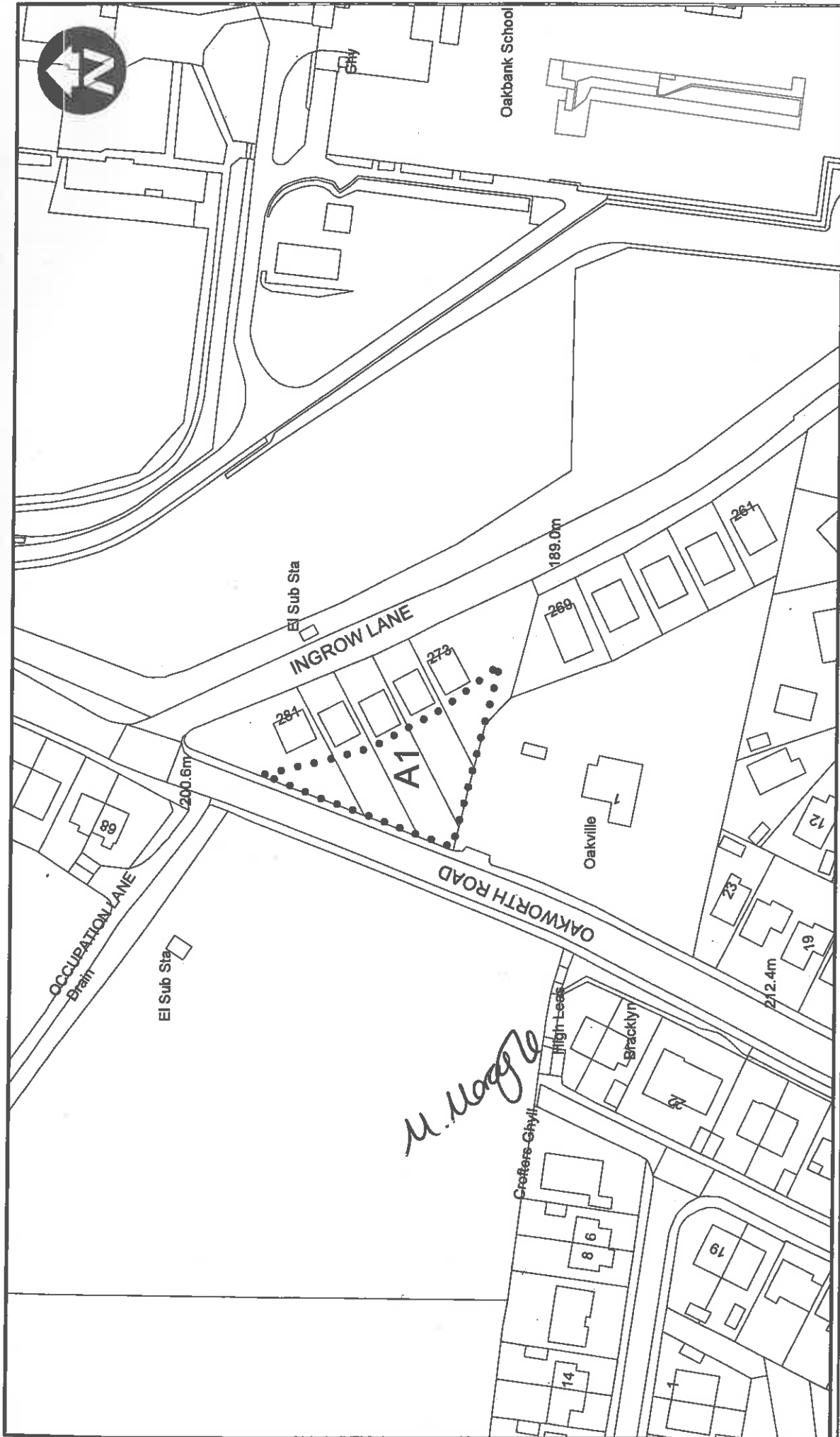

Scale 1: 1,250
OS Ref : SE0439
Reproduced from the Ordnance Survey map with
the sanction of HM Stationery Office
Crown Copyright reserved
LA076120

M. Nagle

TREE PRESERVATION ORDER
LAND AT 273 - 281 INGROW
LANE, KEIGHLEY

DEPARTMENT OF REGENERATION & CULTURE
Jacobs Well
Bradford
BD1 5RW

and 17, or of the Secretary of State in accordance with regulation 23 and, where such consent is given subject to conditions, in accordance with those conditions.

Application to trees to be planted pursuant to a condition

4. In relation to any tree identified in the first column of the Schedule by the letter "C", being a tree to be planted pursuant to a condition imposed under paragraph (a) of section 197 (planning permission to include appropriate provision for preservation and planting of trees), this Order take effect as from the time when the tree is planted.

Dated this 9th day of August 2016.

EXECUTED AS A DEED by affixing
THE COMMON SEAL of THE CITY
OF BRADFORD METROPOLITAN
DISTRICT COUNCIL in the presence of:-



Authorised by the City Solicitor

94340

CONFIRMATION OF ORDER

This Order was confirmed by the City of Bradford Metropolitan District Council without modification on the day of

OR

The Order was confirmed by the City of Bradford Metropolitan District Council subject to the modification indicated by on the day of

EXECUTED AS A DEED by affixing
THE COMMON SEAL of THE CITY
OF BRADFORD METROPOLITAN
DISTRICT COUNCIL in the presence of:-

Authorised by the City Solicitor

REVOCATION OF ORDER

This Order was revoked by the City of Bradford Metropolitan District Council on
the day of

EXECUTED AS A DEED by affixing
THE COMMON SEAL of **THE CITY**
OF BRADFORD METROPOLITAN
DISTRICT COUNCIL in the presence of:-

Authorised by the City Solicitor

SCHEDULE**Specification of Trees****Trees specified individually**(encircled in black on the map)

Reference on map	Description	Situation
NONE		

Trees specified by reference to an area(within a dotted black line on the map)

Reference on map	Description	Situation
A1	ALL TREES OF WHATEVER SPECIES	SE0439

Groups of trees(within a broken black line on the map)

Reference on map	Description	Situation
NONE		

Woodlands(within a continuous black line on the map)

Reference on map	Description	Situation
NONE		